

### 61234 NPT CONNECTION

- 1/2" male water inlets - NPT/sweat
- 1/2" male water outlets - NPT/sweat



### 61236 PEX CONNECTION

- PEX water inlets and top outlet
- 1/2" male bottom water outlet - NPT/sweat



### 61238 WB CONNECTION

- WB water inlets and top outlet
- 1/2" male bottom water outlet - NPT/sweat



## TECHNICAL FEATURES

Solid brass  
 Service Valves and Check Valves  
 Thermostatically limited under 420 C  
 Water flow: 4.5 gpm (17 L / m) at 45psi  
 Max strength accepted by the handle < 22 N  
 Max. Static pressure 145psi (10 bar)  
 Recommended hot supply temperature 65° C or +  
 Installation template for wall cut-out included with the valve

Option: volume restriction screw available

## CHOICE OF TRIMS

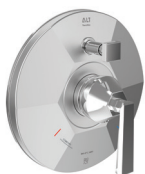

25331



40331



10331



70332



20332



30332

## PRODUCT CHARACTERISTICS

### Description

The ThermOne™ range of mixers automatically adjust hot and cold water to obtain a precise temperature which will never exceed (42°C).

Equipped with the latest generation thermostatic actuator; ThermOne™ will quickly compensate for temperature variations induced by fluctuations in temperature and pressure within hot and cold water supplies.

In case of cold water failure, the thermostatic engine will close the flow of hot water.

ThermOne™ valves meet the most stringent criteria of performance as defined by ASSE 1016 type P(T).

Made of brass and copper ; and equipped with an independent ceramic cartridge (ceramic disks Rubalit®IS95, housing in Grivory-EMS ) ; all internal materials have been selected for their durability and resistance to corrosions.

The ultra-sensitive diverter is designed to provide positive-stop on the outlet not currently in use. At rest, the bottom outlet is automatically pre-selected.

All parts of the valve are accessible from the front.

Unique in design, this thermostatic cartridge makes it possible to adjust not only the temperature, but also the volume in a single movement.

Because of the resulting accuracy, reliability and water savings, the ThermOne™ P(T) series is suitable for applications that require precise and consistent water control: showers and bathtubs in hospitals, hotels, spas as well as residential projects. All the ThermOne™ P(T) valves meet the "Americans with Disabilities Act" (ADA).

## DIMENSIONS

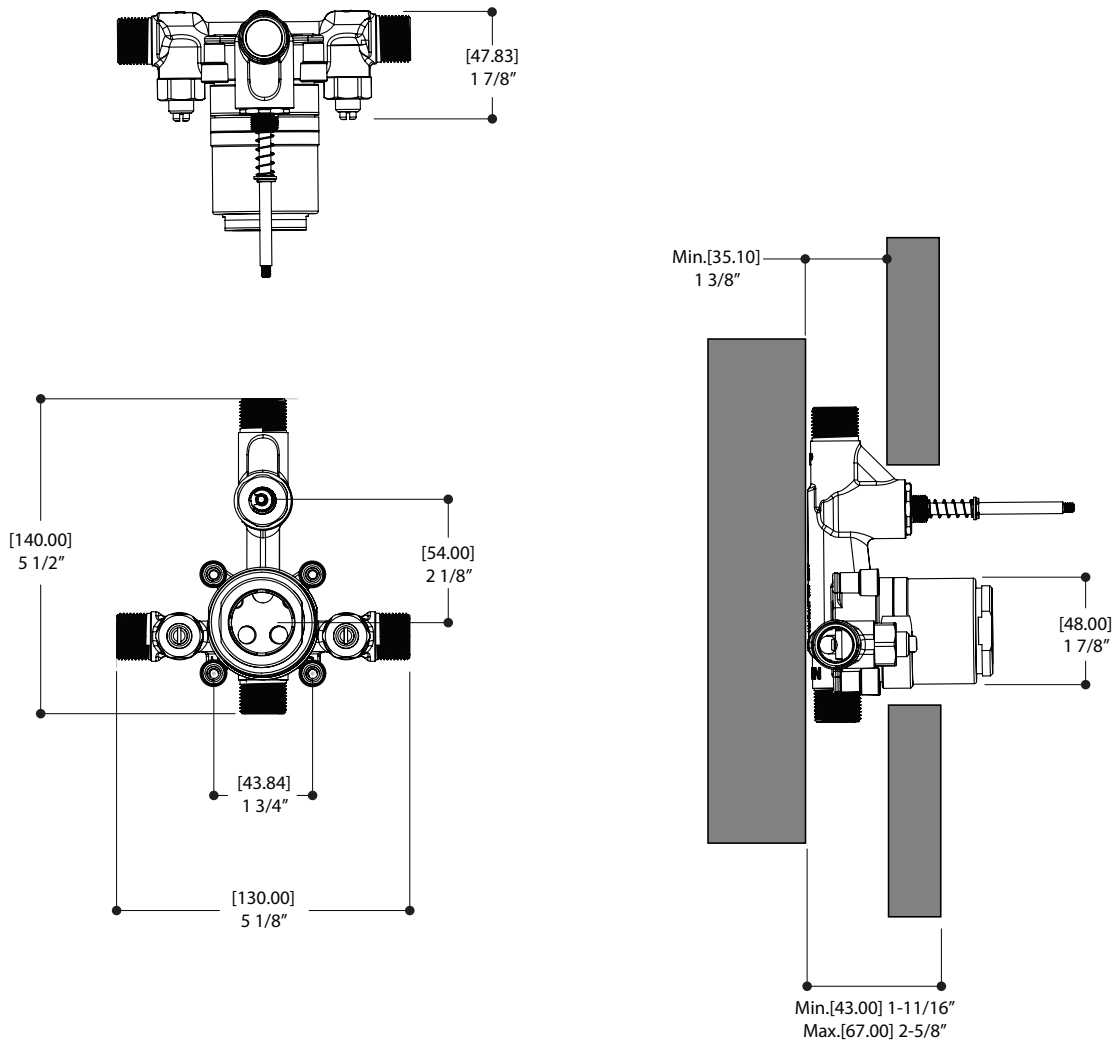

## WARRANTY

ALT products carry a five-year warranty from time of purchase. Cartridges and polished chrome finish for all faucets carry a limited lifetime warranty. The ALT warranty is limited strictly to the original consumer purchaser of the product, as well as first owners of new residential units. The limited warranty is not transferable and is limited to products sold and installed in Canada and the United States. To obtain warranty service, consult [alt-aqua.com/warranty](http://alt-aqua.com/warranty) for further details. All shipping costs are not included and will be charged with applicable taxes. To honour the warranty, ALT products must be installed by a licensed professional plumber.